

IN THE CIRCUIT COURT OF THE 12<sup>TH</sup> JUDICIAL CIRCUIT  
IN AND FOR SARASOTA COUNTY, FLORIDA

STATE OF FLORIDA

Plaintiff,

Case No.: 2021 CF 007559 NC

v.

Joseph D. Gilberti, P.E., a licensed  
Professional Engineer

Defendant

STATE OF FLORIDA

**SUBPOENA FOR HEARING**

**To: US CONGRESSMAN BYRON DONALDS  
FLORIDA DISTRICT 19  
1039 S.E. 9<sup>TH</sup> AVE, SUITE 308  
CAPE CORAL, FL 33990**

**YOU ARE COMMANDED** to appear before a person authorized by law to answer questions regarding a **FRAUDULENT TRANSFER OF GILBERTI and DAUGHTREY LANDS by attorney RYAN SNYDER on October 5, 2020 now OWNED BY SARASOTA COUNTY** using 72 Partners LLC; and another on or about January 2022 while Gilberti is kidnap with fraudulent charges timed with Gilberti vs Pentagon et al., service and a potential School Shooting at his kids School causing the Superintendent in Lee County to quit and the VP of the School; and another recently on February 15, 2023 on the same **FRAUDULENT TRANSFER OF LANDS OWNED BY JOSEPH D. GILBERTI** and his mineral rights for over 2300acres.

**Sarasota to Naples Utilities and Commissioners, FEMA, US CONGRESS, EPA and FDEP with Judges and Cops hiding Clean Antioxidant underground secret Spring water supply to millions of taps to pump AMEOBA WATER to taps that kill US Citizens. All causing a \$5million dollar County and State Tax base Fraudulent Transfer (to hide the RESOURCE and kidnap Gilberti).**

Said property is located at or about 9438 Daughtrey Road, Sidell, Florida 34266. This region uses **UNDUE INFLUENCE** by Circuit 12, 13, 17 and Circuit 20 Judges, Governor Ron Desantis, Carlton Family via Carlton Water plant, Sarasota County Commissioners, Peace River Manasota Water Supply Board and Steve Demarsh hiding US Resource with Sarasota Cops, Judges, Politicians tied to the October 5, 2020 online sale of Cecil Daughtrey lands, Case 2011 CA 04209 NC, utilizing a fraudulent transfer with 72 Partners, Judges and Ed Brodsky's office, Mark Adams, Regional Councils, Chris Hallet, Tom Widen with the County staff to fraud the Citizens of Sarasota and half of Florida and attack Civil Rights of the Defendants pursuant to Title 18 US Code Sec 241 & 242.

**PLACE: Judge Lynn Silvertooth Judicial Center  
HONORABLE JUDGE PADAR CHAMBERS  
2002 RINGLING BLVD – Court Room 4B  
SARASOTA, FLORIDA 34237**

**DATE:** May 30, 2023

**TIME:** 4:00 p.m. to 5:00 p.m.

You are subpoenaed to appear before the Defendant, pursuant to the Notice of Subpoena Duces Tecum and

unless excused from this subpoena by the Defendant or the Court, you shall respond to this subpoena as directed:

**DATED** on this 4<sup>th</sup> day of April, 2023

/s/ Joe Gilberti

Joseph D. Gilberti, PE  
Plaintiff  
385 Donora Blvd  
Ft Myers Beach, FL 33931  
813-470-6000  
[gilbertiwater@gmail.com](mailto:gilbertiwater@gmail.com)

**KAREN E. RUSHING  
CLERK OF THE CIRCUIT COURT**

**BY: \_\_\_\_\_ DATE:**  
**Deputy Clerk**

**If you are a person with a disability who needs any accommodation in order to participate in this proceeding, you are entitled, at no cost to you, to the provision of certain assistance. Please contact the Sarasota County Jury Office, P.O. Box 3079, Sarasota, Florida 34230-3079, (941)861-7400, at least seven (7) days before your scheduled court appearance, or immediately upon receiving this notification if the time before the scheduled appearance is less than seven (7) days; if you are hearing or voice impaired, call 711.**

**CERTIFICATE OF SERVICE**

**I HEREBY CERTIFY** that a true and correct copy was filed at the Sarasota Clerk E-file systems of the foregoing which was furnished via email this 4<sup>th</sup> day of April, 2023 to:

/s/ Joe Gilberti

Joseph D. Gilberti, PE  
Plaintiff  
385 Donora Blvd  
Ft Myers Beach, FL 33931  
813-470-6000  
[gilbertiwater@gmail.com](mailto:gilbertiwater@gmail.com)

**LANDTECH DESIGN GROUP, INC.**  
Planning, Engineering & Consulting Services  
385 Donora Blvd  
Fort Myers Beach, Florida 33931  
813-470-6000 Direct  
[gilbertiwater@gmail.com](mailto:gilbertiwater@gmail.com)

March 27, 2023

US Certified Mail \_\_\_\_\_

US Congressman Byron Donalds, Florida's 19<sup>th</sup> Congress  
3299 Tamiami Trail East  
Suite 105  
Naples, Florida 34112  
(239) 252-6225

**SUBJECT: H.R. 9581 -117<sup>th</sup> Congress (2021-2022) –**  
Blue Gold Antioxidant Spring Water Pipeline along Seminole Rail Right of Way  
for Economic Growth, Disaster Relief Lower Cancer/Disease Rates at Taps, NO  
Water Restrictions for Regional Drinking Water Supply Sustainability/Resiliency

**PROJECT: CLOSER TO THE HEART – 75 mile Blue Gold Pipeline (Manatee to Naples)**  
- Peace River Manasota Water Supply Loop Option & West Florida  
Alignment down CSX/Seminole Gulf Railway

**RE: Request for Special Presentation to assist in H.R. 9581, New Medicine,  
National Defense, FEMA Stafford Act Pro Active Relief for Hurricane Ian**  
-Include our Florida and New York/New Jersey Blue Gold Transmission  
Project(s) in H.R. 9581  
-Obtain Executive Order from Desantis or Biden for Water Supply and  
new National Defense Resources in Water Supply found.  
-Future Sustainability, Healthcare and Job Growth from new underground  
unique Resources.

Dear US Congressman Byron Donalds,

My name is Joseph Gilberti, P.E., I live on Fort Myers Beach, who met you a month ago  
at the Bonita Spring Town Hall meeting held at the Church on February 21, 2023. I mentioned  
the COVID19 mask shown on our US Concurrency (\$20bill) since 1999.

The reason for this letter is we want to meet in person at your office or our large  
Sarasota/Manatee/Desoto Ranch property with a **Secret underground River**, to present this 10-  
year public record Spring Water Infrastructure project in Florida and another in New York for

Regional water supply and Global knowledge hidden from the Public on Water Supply that can ride along your House Bill for Short Rail Disaster Relief via H.R. 9581 recently brought to Americans in December 2022 due to Hurricane Ian. I live on Fort Myers Beach so we appreciate the help and consideration.

This Natural Resource and critical underground knowledge to find more in days via underground Secret River from Meteor Impact has been hidden by FEMA and others to increase risks to Americans in all directions. It has been verified by Energy consultants and more and my civil rights have been attacked by the DOJ for years to hide it. My kids and family have been attacked at all levels of law enforcement crooked Judges and Lawyers to hide this World Resource from Americans.

My plan prior to Hurricane Ian was an alignment down the old Seminole Gulf Railway, which can be better used for Water Supply transmission, but we can use both or mitigate a future rail down the future 10 lane widening planned down FDOT US I-75 from Sarasota to Naples. This phasing can be more clearly explained to tandem your efforts with Seminole Gulf Railway and west Florida home owners and businesses.

We have discovered a unique underground river showing water and health readings off the chart, that is ready to install at 6' Blue Gold Pipeline from our Ranch in Sarasota south to Peace River Water Plant (see Manatee and Lee County workshop letters and FDEP Permits corres) and continue down old Seminole Gulf Railway to Naples bringing FIJI Water to the Tap using the Train for supplies to finish quicker as a team.

This project includes a Master build out plan to install two additional 9-dia Transmissions for Southwest Florida and South Florida as shown on our Website cover page at [www.gilbertbluegold.com](http://www.gilbertbluegold.com) since 2015. These documents have been submitted to FDOT District 1, 3, 4, 5 & 6, EPA, FEMA, Governor Ron Desantis and all Commissioners from Tampa to Miami with many video presentations from Cancer Victims, Children, Professionals and Court showing the major attention surrounding this secret underground resource hidden by the Media for some reason.

The Florida resource is from a buried Meteor Impact and titled Florida Platform per our Energy consultants; while the New Jersey resource is a buried Volcano at the Washtung Mountains or as we know "Washington Rock" just 25miles east and 500feet above a City that is under risk of aqua ducts collapsing causing a Catastrophic Event. Both resources are near CSX

Right of way that we can inside information that CSX and FEMA knew of the resources prior to many Hurricanes such as but not limited to, Hurricane Sandy and Hurricane Ian.

With your help, voice in Southwest Florida, and our coordination with local universities we can potentially get both your H.R. Bill passed with much more Grant assistance with a far Greater Return to the People, not just the railway company's operation pursuant to your proposal.

## H.R.9581 - Short Line Railroad Relief Act 117th Congress (2021-2022)

### BILL

Hide Overview

**Sponsor:** [Rep. Donalds, Byron \[R-FL-19\]](#) (Introduced 12/15/2022)

**Committees:** House - Transportation and Infrastructure

**Latest Action:** House - 12/16/2022 Referred to the Subcommittee on Railroads, Pipelines, and Hazardous Materials. ([All Actions](#))

**Tracker: Tip** This bill has the status Introduced  
Here are the steps for Status of Legislation:

#### 1. Introduced

### Byron Donalds Champions the Short Line Railroad Relief Act

By  
**Kevin Derby**

-  
December 22, 2022, 3:00 pm

*In the final days of the current Congress, U.S.Rep. **Byron Donalds**, R-Fla., is pushing the “**Short Line Railroad Relief Act**.”*

*The bill, which Donalds introduced last week, “authorizes the establishment of a disaster relief program to provide much-needed immediate financial assistance to our nation’s short line railroads.”*

*Donalds explained why he was championing the proposal.*

*“Hurricane Ian devastated various areas of Southwest Florida and among one of the hardest hit entities was the catastrophic damage to Seminole Gulf Railway. When a storm of this magnitude*

*and destruction hits any area of our nation, it is the federal government's responsibility to make available the necessary resources to rebuild and restore vital components of a community. The Short Line Railroad Relief Act isn't a measure to rubberstamp reckless spending; this bill establishes a means for critical relief for American short line railroads in the event of catastrophic damage following a natural disaster," Donalds said.*

*"The United States is home to more than 600 small business short-line freight railroads that have a vital role in transporting materials from various economic sectors, such as: industrial manufacturing, agriculture, energy, chemicals, minerals, metals, timber, and much more. Currently, federal programs fail to provide short line railroads with immediate financial relief after natural disasters," the congressman's office noted.*

Six House Republicans are backing the bill as co-sponsors. The bill was sent to the U.S. House Transportation and Infrastructure Committee which referred it to the U.S. **House Railroads, Pipelines, and Hazardous Materials Subcommittee**. So far, there is no companion measure in the U.S. Senate.

[Kevin Derby](#)

Originally from Jacksonville, Kevin Derby is the editor of Florida Daily and covers politics across Florida. Reach Kevin at [kevin.derby@floridadaily.com](mailto:kevin.derby@floridadaily.com)

## **SPECIAL PRESENTATION AND MEETING REQUEST**

This is a request to meet to discuss the above project. This project brings the following benefits to your tax payers with no cost to them.

- Endless FIJI quality spring water to taps Sarasota to Naples
- No Water Restrictions and higher resilience from Natural Disaster
- Lower Water and Energy Bills throughout West Florida
- No dependency on rain or river discharges or sea level rise
- Major increase in Health, Environment and Economic Sustainability from hidden underground resource
- No Pollution/Red Tide/GMO worries along Rivers for Drinking Water

We are proposing to pay and finish the loop option and wish coordinate with the Commission, staff and Manatee Ports for a much higher level of service in Water Quality and Supply from a secret underground River on Daughtrey/Flint Properties. This natural resource brings Economic drivers to widen S.R. 64 and S.R. 70 across the State and become a major trade in Farming, Food and Natural Defense to both Florida and the United States.

The Project not only completes the half built Loop Option stalled since the 1990's while adding a new 75mile Blue Gold Transmission (Antioxidant Spring Water) and 16-inch Airport

Fuel Transmission pipeline down the old CSX/Seminole Railway right of way that was recently destroyed even further from Hurricane Ian giving us Grant opportunities for new Transmission bridges and move the Train to a High Speed Rail on I-75 for future Long Range Transportation elements already imposed at FDOT District 1 in 2013. This will coordinate with an INTERCONNECT WATER SYSTEM to Manatee, Sarasota, Desoto, Charlotte, Lee and Collier Counties and their multiple Cities and private CDD's within.

An application to the FDEP State Revolving Fund which allows matching funds from FEMA can work with the Disaster Relief House Bill you propose in the next months to bring millions the healthiest Water to the Tap ever seen on Earth, many housing jobs and a potential Alkaline Housing Boom and model this project and the New York Project bring to America and other Nations once we all share this underground unique knowledge for unique Water supply resources hidden deep underground.

**Please contact the Ranch owner(s) Robert Flint at 863-990-0932** or myself at your earliest convenience to discuss this unique unlimited Natural Resource we are offering to the Public, so we can meet with you in person to discuss the project and how we can help your community very quickly. We would also like to invite you to the property to test the resource yourself with staff so we can expedite the coordination of the HIGHER LEVEL OF SERVICE raw drinking water resource for the region.

**LANDTECH DESIGN GROUP, INC.**

Regards,

*Joe Gilberti*

Joseph D. Gilberti, Jr., PE  
President  
385 Donora Blvd  
Fort Myers Beach, Florida 33931  
[Gilbertiwater@gmail.com](mailto:Gilbertiwater@gmail.com)  
[www.gilbertibluegold.com](http://www.gilbertibluegold.com)  
813-470-6000

cc:\ PRWSA\USGS\FDEP\FDOH\FDOT\Hospitals\ACOE\Joe Biden\CSX\Seminole Gulf Railway\Ron Desantis\FDEP\Dept of Health Naples to Tampa\RF\RM\ELA\CD\AE\

Enclosures

## EXHIBIT A

*Permitted Alignment plans to Peace River Manasota that ties to CSX/Seminole Railway down to Marco Island from Sarasota from EPA hidden Secret underground access to Oceans of Spring Water to the Taps of Millions with Medicine aspects (350MGD to 750MGD)*

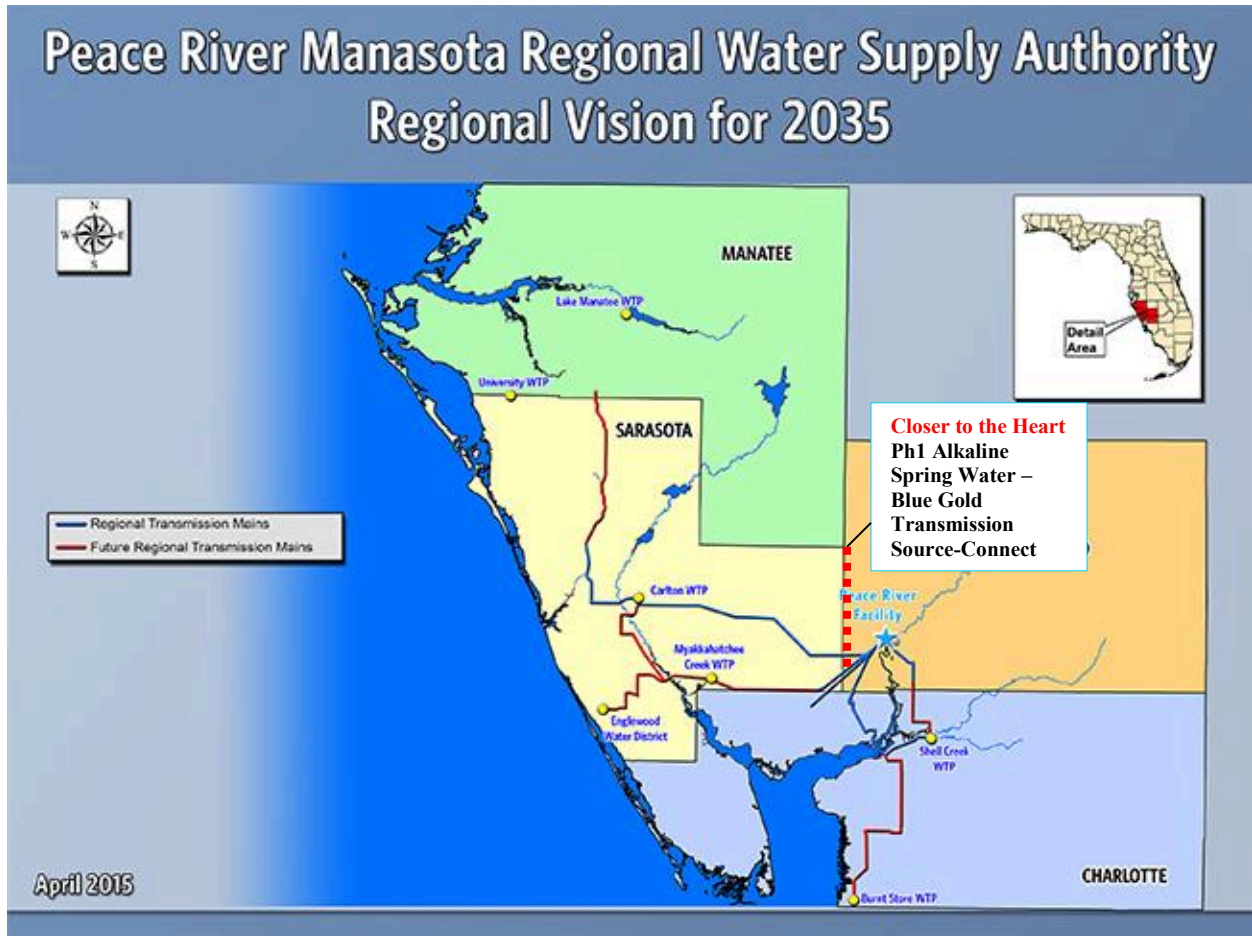

Connection from S.R. 72 Clark Road Tri-County Monument at Flint Farms Peace River Loop Option  
See attached Engineering Plans submitted to FDEP Jon Iglehart Fort Myers Office May 2020 approved by Desoto  
County and ready to start Construction to serve Taps.



## EXHIBIT B

*Existing Seminole Gulf Railway/CSX being replaced by Blue Gold and Airport Fuel Transmission to lower Fuel Truck Traffic and provide FREE HEALTHCARE at the Tap of Homes, Hospitals, Schools and Businesses*



# EXHIBIT C

## CLOSER TO THE HEART

### "A Sustainable Water Supply for South Florida"

(9FT DIAMETER ALKALINE SPRING WATER TRANSMISSION TO WEST FLORIDA TAPS)  
 -250MGD TO 350MGD--  
 Lower Utility Bills and Cancer Rates - 5million REAL JOBS

**FLORIDA AGENCIES HIDING RESOURCE**

**POTENTIAL PARTNERS FOR STRATEGIC ALLIANCE**

**FLORIDA UNIVERSITIES**

**ENGINEER OF RECORD**

JOSEPH B. GILBERTI, P.E.  
 JULY 16, 2019

**LANDTECH**  
 design group, inc.

PLANNING, ENGINEERING AND CONSULTING  
 AND CONSTRUCTION  
 100 W. WASHINGTON ST. SUITE 1000  
 TAMPA, FLORIDA 33601  
 TEL: 813-271-0000  
 WWW.LANDTECHDESIGN.COM

## GILBERTI BLUE GOLD

### "Revitalizing National Defense, Health, Economy and Environment"

MASTER ALIGNMENT AND INVESTOR EXHIBIT - BLUE GOLD WEST FLORIDA

PDF generated by iTextPDF Creator Trial - Get it at <http://www.itextpdf.com>

## EXHIBIT D

*Bring Healthiest Antioxidant and Foods to major expansion and Jobs at Manatee Ports via Panama Canal Trade for overall Economic Growth, Cruise-line tourism and Food Production in Eastern Myakka Ranchlands from unique water supply and Technology*

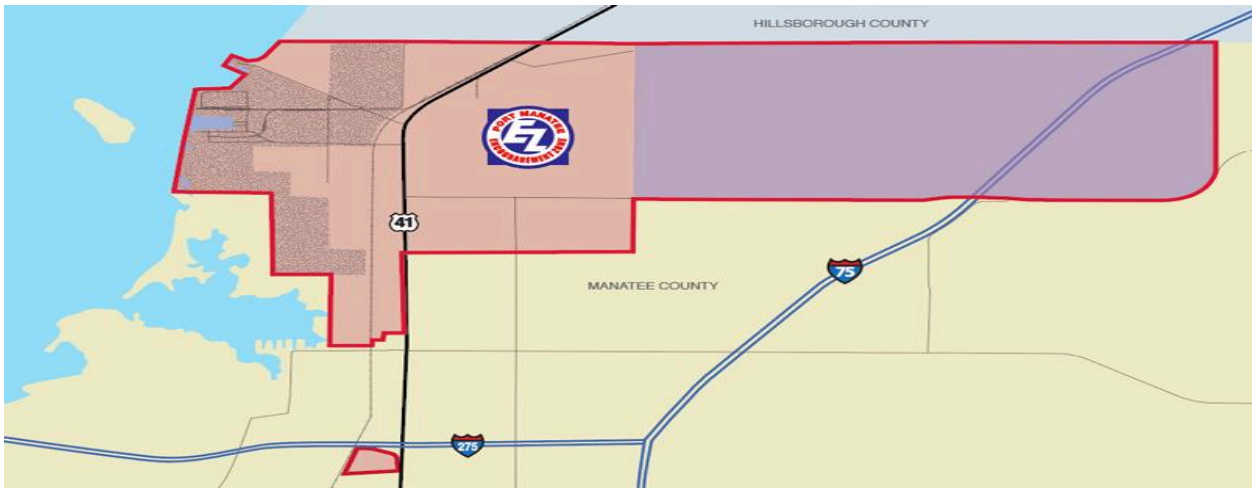
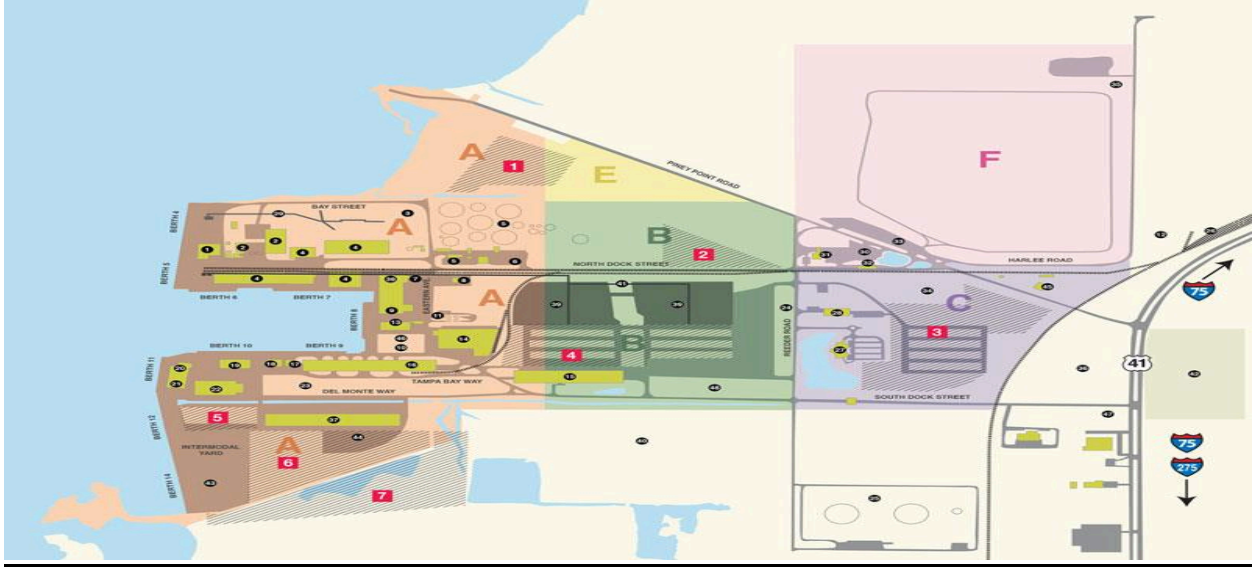

## EXHIBIT E

*Health Scan of Water Readings unique to Human Health and Economic Sustainability to the South Florida Regions to lower utility costs and taxes*



**Report #:** 11712156

**Date :** 11/7/2012

**P.O.Number:** 102 Ck

Same as Client

**Matrix:** Well Water

**Client:** Cecil Daughtrey Jr.

**Sample** 9438 Daughtrey Rd

**Location** Sidell FL 34266

**Phone** (813) 470-6000

This sample taken by Joe Gilberti, P.E. at 3:00:00 PM on 10/24/2012. . Point of collection: Well #2

### Health Scan Report

	<b>Results</b>		<b>Public Drinking Water EPA Limits</b>
<b><u>General Bacteria</u></b>			
Total Coliform	Absent	Animal or Vegetational Bacteria	0
Fecal/E. Coli	Absent	Animal Bacteria	0
<b><u>MicroAnalysis</u></b>			
MicroAnalysis	See Attached		
<b><u>General Chemistry</u></b>			
Sodium	74.05 mg/L	20.0 mg/L is Mass. DEP Guideline	250.0 mg/L
Potassium	4.11 mg/L	A Component of Salt	No Limit
Copper	Not Detected	Indicates Plumbing Corrosion	1.30 mg/L
Iron	0.64 mg/L	Brown Stains, Bitter Taste	0.30 mg/L
Manganese	Not Detected	May Cause Laundry Staining	0.05 mg/L
Magnesium	71.90 mg/L	A Component of Hardness	No Limit
Calcium	118.20 mg/L	A Component of Hardness	No Limit
Arsenic	Not Detected	A Toxic Metal	0.010 mg/L
Lead	Not Detected	A Toxic Metal	0.015 mg/L
Zinc.	Not Detected	A Toxic Metal	5.0 mg/L
pH	7.49 SU	Acid/Basic Determination	6.5 - 8.5 SU
Turbidity	0.49 N.T.U.	Presence of Particles	No Limit
Color	Not Detected	Clarity (0), Discoloration (15)	15.0 C.U.
Odor	Not Detected	Odor due to Contamination	3.0 T.O.N.
Conductivity	1771.0 umhos	Electrical Resistance (umhos/cm)	No Limit
T.D.S.	1,062.6 mg/L	Total Dissolved Minerals Present	500.0 mg/L
Sediment	Absent	Undissolved Solids	Present
Alkalinity	170.0 mg/L	Ability to Neutralize acid	No Limit
Chlorine	Not Detected	A Disinfectant	4.0 mg/L
Chloride	206.13 mg/L	A component of salt	250.0 mg/L
Hardness	591.2 mg/L	0 - 75 is considered soft	No Limit
Nitrate as Nitrogen	0.29 mg/L	Indicator of Biological Waste	10.0 mg/L
Nitrite as Nitrogen	Not Detected	Indicator of Waste	1.0 mg/L
Ammonia as Nitrogen	0.497 mg/L	Indicator of Waste	No Limit
Sulfate	851.40 mg/L	A Mineral, Can Cause Odor	250.0 mg/L
<b><u>Radiochemistry</u></b>			
Radon in Water	Not Detected	Massachusetts D.E.P. Guideline	10,000 pCi/L

The integrity of the sample and results are dependent on the quality of sampling. The results apply only to the actual sample tested. Environmental Testing and Research Laboratories shall be held harmless from any liability arising out of the use of such results.

60 Elm Hill Ave.    Leominster MA 01453-4864    (978) 840-2941    (800) 344-9977    **Page 1 of 3**  
 info@etrilabs.com    www.etrilabs.com

# EXHIBIT E (Continued)



Report #: 11712156

Date : 11/7/2012

P.O.Number: 102 Ck

Same as Client

Matrix: Well Water

Client: Cecil Daughtrey Jr.

Sample 9438 Daughtrey Rd

Location Sidell FL 34266

Phone (813) 470-6000

This sample taken by Joe Gilberti, P.E. at 3:00:00 PM on 10/24/2012. . Point of collection: Well #2

## Health Scan Report

Results	Public Drinking Water EPA Limits
<b><u>Organic Analysis</u></b>	
Benzene	Not Detected 5.0 ug/L
Bromobenzene	Not Detected No Limit
Bromochloromethane	Not Detected No Limit
Bromodichloromethane	Not Detected No Limit
Bromoform	Not Detected No Limit
Bromomethane	Not Detected No Limit
n-Butylbenzene	Not Detected No Limit
sec-Butylbenzene	Not Detected No Limit
tert-Butylbenzene	Not Detected No Limit
Carbon-Tetrachloride	Not Detected 5.0 ug/L
Chlorodibromomethane	Not Detected No Limit
Chloroethane	Not Detected No Limit
Chloroform	Not Detected No Limit
Chloromethane	Not Detected No Limit
1,2-Chlorotoluene	Not Detected No Limit
1,4-Chlorotoluene	Not Detected No Limit
1,2-Dibromo-3-chloropropane	Not Detected No Limit
Dibromomethane	Not Detected No Limit
1,2-Dibromomethane	Not Detected No Limit
1,3-Dichlorobenzene	Not Detected No Limit
1,2-Dichlorobenzene	Not Detected 600.0 ug/L
1,4-Dichlorobenzene	Not Detected 5.0 ug/L
Dichlorodifluoromethane	Not Detected No Limit
1,1-Dichloroethane	Not Detected No Limit
1,2-Dichloroethane	Not Detected 5.0 ug/L
1,1-Dichloroethylene	Not Detected 7.0 ug/L
cis-1,2-Dichloroethene	Not Detected 70.0 ug/L
trans-1,2-dichloroethene	Not Detected 100.0 ug/L
1,2-Dichloropropane	Not Detected 5.0 ug/L
1,3-Dichloropropane	Not Detected No Limit
2,2-Dichloropropane	Not Detected No Limit
1,1-Dichloropropene	Not Detected No Limit
1,3-Dichloropropene	Not Detected No Limit
trans-1,3-Dichloropropene	Not Detected No Limit
Ethylbenzene	Not Detected 700.0 ug/L
Fluorotrichloromethane	Not Detected No Limit

The integrity of the sample and results are dependent on the quality of sampling. The results apply only to the actual sample tested. Environmental Testing and Research Laboratories shall be held harmless from any liability arising out of the use of such results.

60 Elm Hill Ave. Leominster MA 01453-4864 (978) 840-2941 (800) 344-9977 Page 2 of 3  
info@etrilabs.com www.etrilabs.com

# EXHIBIT E

(Continued)



Report #: 11712156

Date : 11/7/2012

P.O.Number: 102 Ck

Same as Client

Matrix: Well Water

Client: Cecil Daughtrey Jr.

Sample Location: 9438 Daughtrey Rd

Sidell FL 34266

Phone (813) 470-6000

This sample taken by Joe Gilberti, P.E. at 3:00:00 PM on 10/24/2012. . Point of collection: Well #2

## Health Scan Report

	Results	Public Drinking Water EPA Limits
Hexachlorobutadiene	Not Detected	No Limit
Isopropylbenzene	Not Detected	No Limit
Methyl-t-Butyl Ether (MTBE)	Not Detected	Massachusetts DEP Limit 70.0 ug/L
p-Isopropyltoluene	Not Detected	No Limit
Methylene Chloride	Not Detected	5.0 ug/L
Monochlorobenzene	Not Detected	100.0 ug/L
Napthalene	Not Detected	No Limit
n-Propylbenzene	Not Detected	No Limit
Styrene	Not Detected	100.0 ug/L
1,1,1,2-Tetrachloroethane	Not Detected	No Limit
1,1,2,2-Tetrachloroethane	Not Detected	No Limit
Tetrachloroethylene	Not Detected	5.0 ug/L
Toluene	Not Detected	1000.0 ug/L
1,2,3-Trichlorobenzene	Not Detected	No Limit
1,2,4-Trichlorobenzene	Not Detected	70.0 ug/L
1,1,1-Trichloroethane	Not Detected	200.0 ug/L
1,1,2-Trichloroethane	Not Detected	5.0 ug/L
Trichloroethylene	Not Detected	5.0 ug/L
1,2,3-Trichloropropane	Not Detected	No Limit
1,2,4-Trimethylbenzene	Not Detected	No Limit
1,3,5-Trimethylbenzene	Not Detected	No Limit
Vinyl Chloride	Not Detected	2.0 ug/L
o-Xylene	Not Detected	T. Xylenes 10K ug/
m+p Xylenes	Not Detected	T. Xylenes 10K ug/

The integrity of the sample and results are dependent on the quality of sampling. The results apply only to the actual sample tested. Environmental Testing and Research Laboratories shall be held harmless from any liability arising out of the use of such results.

60 Elm Hill Ave.    Leominster MA 01453-4864    (978) 840-2941    (800) 344-9977    Page 3 of 3  
 info@etr labs.com    www.etr labs.com

## EXHIBIT F

### *FDEP Fort Myers Lee County- Record Permitting*



## **FLORIDA DEPARTMENT OF Environmental Protection**

South District  
PO Box 2549  
Fort Myers FL 33902-2549  
[SouthDistrict@FloridaDEP.gov](mailto:SouthDistrict@FloridaDEP.gov)

**Ron DeSantis**  
Governor

**Jeanette Nuñez**  
Lt. Governor

**Neah Valensstein**  
Secretary

October 19, 2020

Joseph Gilberti, P.E.  
[gilbertiwater@gmail.com](mailto:gilbertiwater@gmail.com)

Re: DeSoto County – Potable Water  
Facility Name: Closer to the Heart  
Facility ID: 6142734  
DEP Application No.: 78714-026-DS

Dear Mr. Gilberti:

Thank you for your application for your concern about the processing of your application for the Closer to the Heart Project. We asked for signatures from the utility on the application form, a Public Service Commission Certification and authorization from the owners of the lands the water line will go through. You requested a dryline permit to allow for more time to secure the authorizations. All permits are issued with these authorizations. Dryline permits are issued when critical facilities (such as pump stations and treatment facilities) have not been built.

These are the reasons we need the authorizations:

Your project will provide water to the Peace River Manasota Regional Water Supply Authority. This utility must sign the application to bind itself to ensure proper operation.

We need approval from the owners of the properties where the pipeline will be installed. The Department may not convey any rights, privileges, title of other entities' properties. That permission must come from the property owner.

We need a copy of the Public Service Commission's (PSC) certificate authorizing you to provide the water service. This certificate is required for every public water system in DeSoto County. This certificate grants you the service territory for water. Without the certificate the Department may not issue a permit.

Without these approvals, any permit the Department issues will not meet the minimum requirements for water systems. Our intent is to permit projects that meet the basic requirements. When the project conforms to the rules, we can successfully defend challenges in court.

I also asked by email on June 24 about plans and construction through the wetlands as well as diameters for flushing stations. These questions are not as critical as securing the authorizations. I can authorize up to 90 more days for you to provide the authorizations. Please let me know if you need it.

I hope this letter clarifies the Department's needs for permitting.

Sincerely,

A handwritten signature in blue ink that reads "Nolin Moon".

Nolin Moon  
Environmental Administrator

**EXHIBIT F**

*Access to secret Under-ground River from Tilted Platform via KT Event  
With  
Phase 1 Engineering Plans to Peace River WTP per FDEP Permit review*





## EXHIBIT G



November 22, 2021

To Whom it May Concern:

Re: CLOSER TO THE HEART

Over the past 13 years I have supervised & used downhole video units and water quality logging trucks in a variety of areas including Closer to the Heart. Based on the results obtained during our pull back zone testing, water quality is extremely good for both the area and depth, the pH values during zone testing ranged from 7.8 to 11

If you have any questions about the above information or if we may be of any further assistance please don't hesitate to call. Thank you.

Sincerely,

*Jim Murray*

Jim Murray  
President

# EXHIBIT H

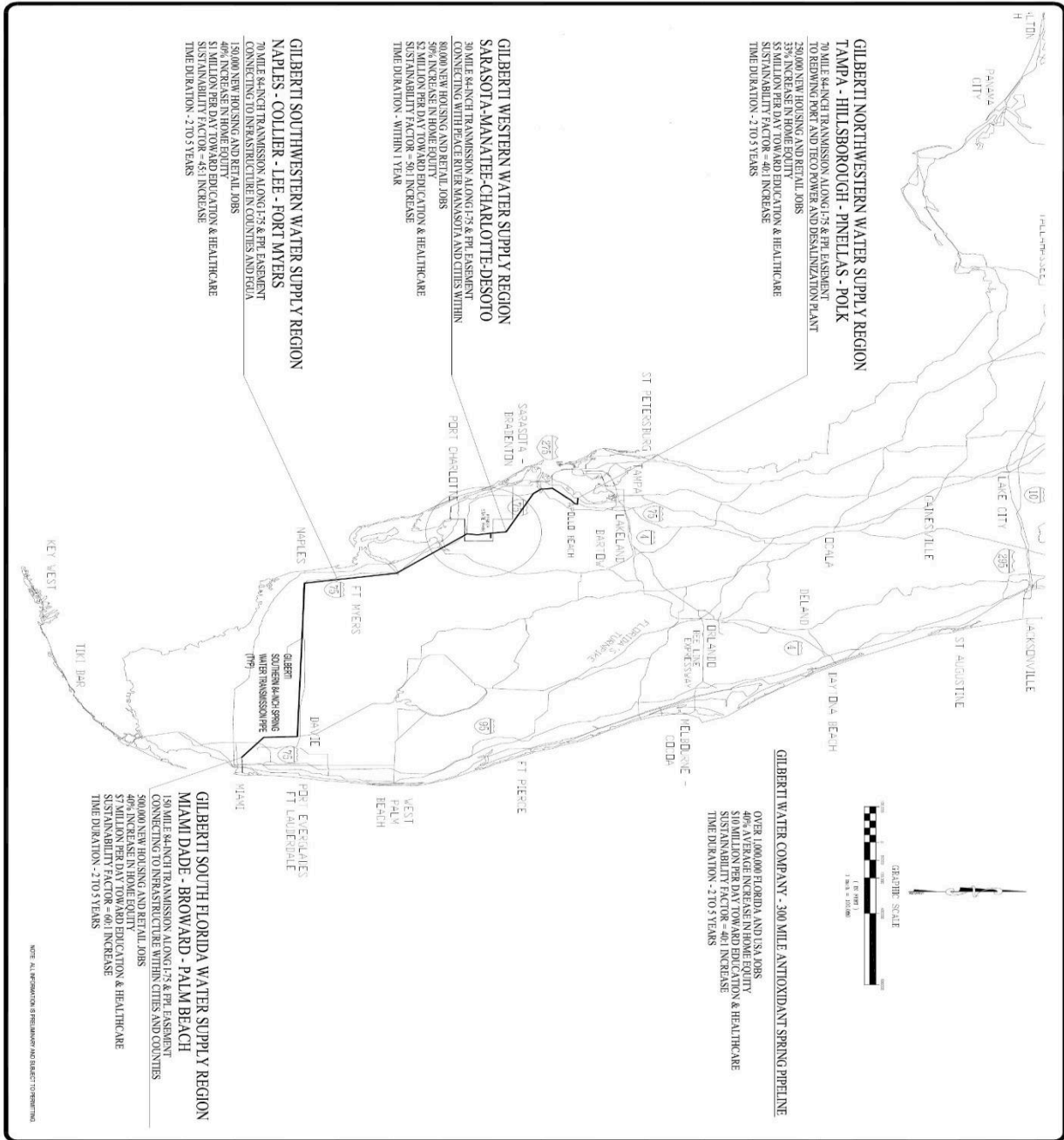

DATE	BY	REV.
10/20/11	MM	1
10/20/11	MM	2
10/20/11	MM	3
10/20/11	MM	4
10/20/11	MM	5
10/20/11	MM	6
10/20/11	MM	7
10/20/11	MM	8
10/20/11	MM	9
10/20/11	MM	10

**LANDTECH DESIGN GROUP, INC.**  
 REAL ESTATE DEVELOPMENT & CONSULTING  
 1275 LEE BLVD., SUITE 200  
 FORT MYERS, FLORIDA 33901  
 813-470-6000  
 813-470-6001  
 www.landtechdesigngroup.com  
 CERTIFICATE OF AUTHORIZATION No. 22864

**CLOSER TO THE HEART**  
 ANTOXIDANT SPRING WATER AND SOUTHERN  
 FLORIDA POTABLE TRANSMISSION SYSTEM  
 JOSEPH D. GILBERTI, P.E., LAND OWNER  
 INTERSTATE SPRING TRANSMISSION SERVICE AREA

DATE	REVISION	BY

# EXHIBIT I-1

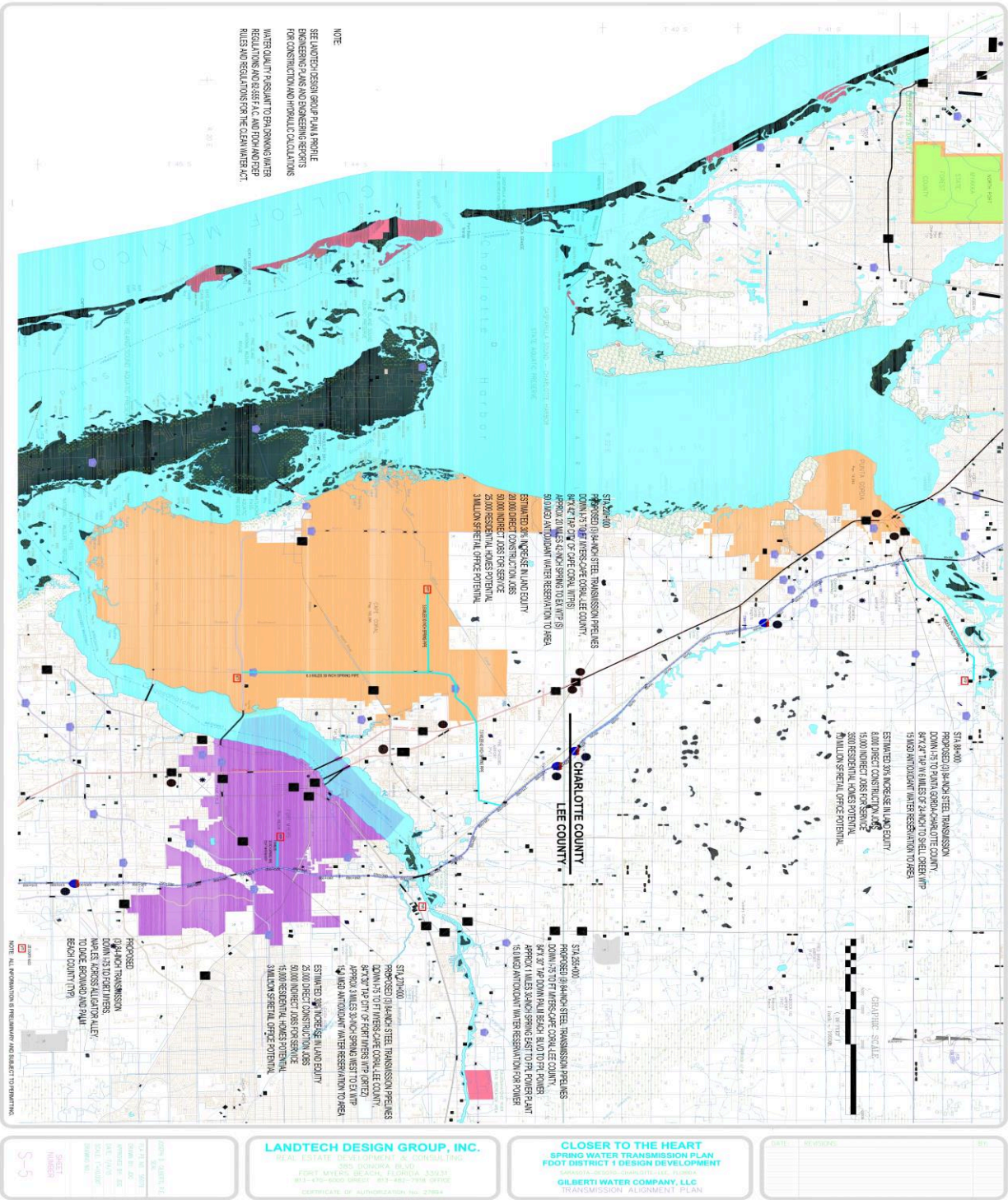

PDF Created with deskPDF PDF Writer - Trial :: <http://www.docudesk.com>

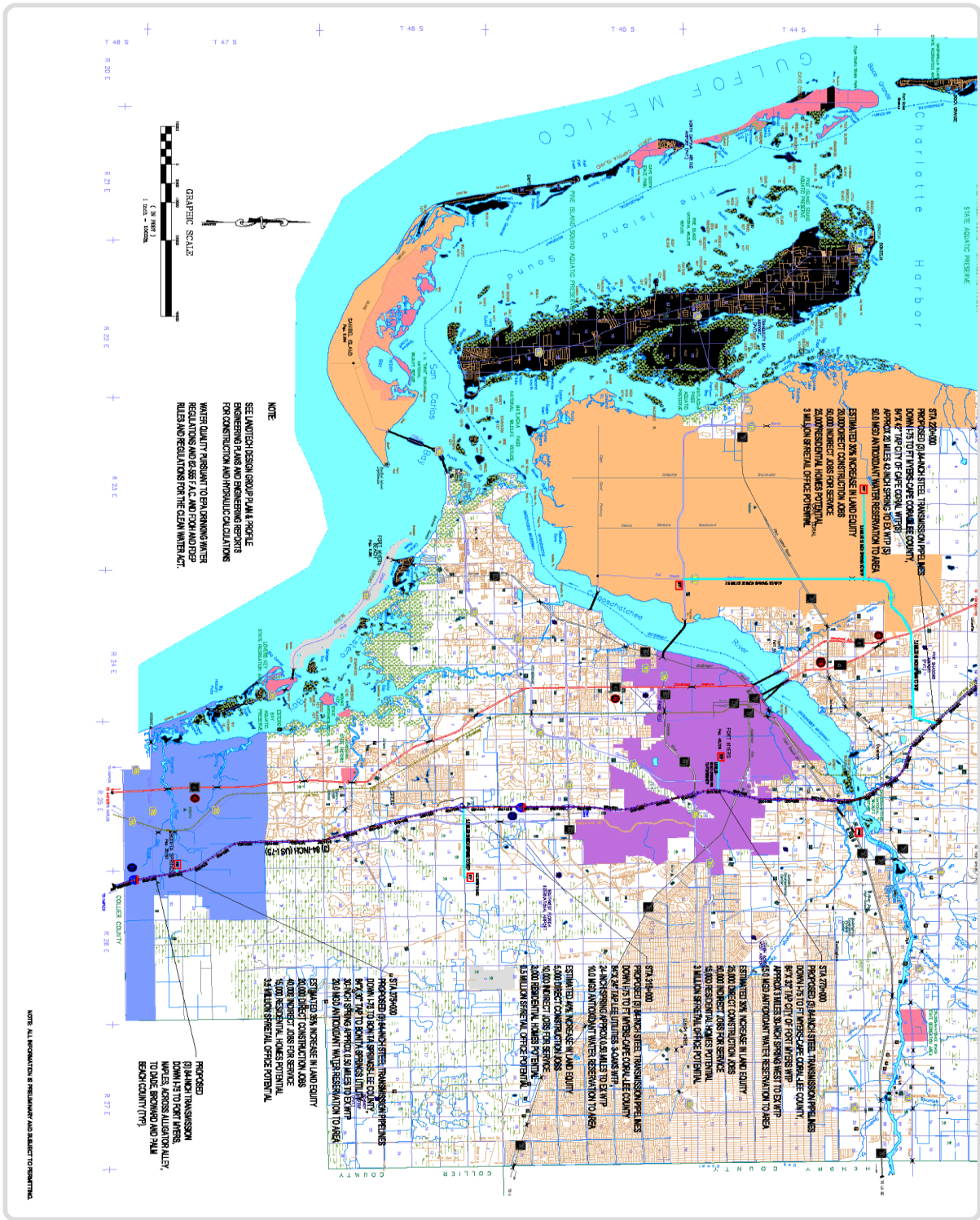

**NOTE:**  
 SET LINED DESIGN GROUP P.L.A. PEOPLE  
 ENGINEERING PLANS AND ENGINEERING REPORTS  
 FOR CONSTRUCTION AND HYDRAULIC CALCULATIONS  
 WATER QUALITY RESULTANT TO DRINKING WATER  
 RESULTS AND USES F.A.C. AND F.O.M. AND REPLY  
 RULES AND REGULATIONS FOR THE CLEAN WATER ACT.

**SIT 26/000**  
 PROPOSED 36" DIAMETER TRANSMISSION PIPE LINES  
 DOWN 1/4" TO FT. WESS-CAMP COUPEE COUNTY  
 FROM THE CITY OF CHARLOTTE, WITH A 10'  
 3" MINIMUM WATER RESERVATION TO AREA  
 ESTIMATED NEW INCREASE IN LAND EQUITY  
 20,000 DIRECT CONSTRUCTION JOBS  
 5,000 INDIRECT JOBS FOR SERVICE  
 3 MILLION SPENDING OFFICE POTENTIAL

**PROPOSED**  
 36" DIAMETER TRANSMISSION  
 PIPE LINES ACROSS ALLUVIDOR ALLEYS,  
 TO DUNE BROWARD AND TALL  
 BEACH COUNTY TYP.

**SIT 31/000**  
 PROPOSED 36" DIAMETER TRANSMISSION PIPE LINES  
 DOWN 1/4" TO BOWEN SPRINGS, LEE COUNTY,  
 FROM THE CITY OF CHARLOTTE, WITH A 10'  
 3" MINIMUM WATER RESERVATION TO AREA  
 ESTIMATED NEW INCREASE IN LAND EQUITY  
 20,000 DIRECT CONSTRUCTION JOBS  
 5,000 INDIRECT JOBS FOR SERVICE  
 3 MILLION SPENDING OFFICE POTENTIAL

**SIT 31/000**  
 PROPOSED 36" DIAMETER TRANSMISSION PIPE LINES  
 DOWN 1/4" TO BOWEN SPRINGS, LEE COUNTY,  
 FROM THE CITY OF CHARLOTTE, WITH A 10'  
 3" MINIMUM WATER RESERVATION TO AREA  
 ESTIMATED NEW INCREASE IN LAND EQUITY  
 20,000 DIRECT CONSTRUCTION JOBS  
 5,000 INDIRECT JOBS FOR SERVICE  
 3 MILLION SPENDING OFFICE POTENTIAL

**SIT 31/000**  
 PROPOSED 36" DIAMETER TRANSMISSION PIPE LINES  
 DOWN 1/4" TO BOWEN SPRINGS, LEE COUNTY,  
 FROM THE CITY OF CHARLOTTE, WITH A 10'  
 3" MINIMUM WATER RESERVATION TO AREA  
 ESTIMATED NEW INCREASE IN LAND EQUITY  
 20,000 DIRECT CONSTRUCTION JOBS  
 5,000 INDIRECT JOBS FOR SERVICE  
 3 MILLION SPENDING OFFICE POTENTIAL

**SIT 31/000**  
 PROPOSED 36" DIAMETER TRANSMISSION PIPE LINES  
 DOWN 1/4" TO BOWEN SPRINGS, LEE COUNTY,  
 FROM THE CITY OF CHARLOTTE, WITH A 10'  
 3" MINIMUM WATER RESERVATION TO AREA  
 ESTIMATED NEW INCREASE IN LAND EQUITY  
 20,000 DIRECT CONSTRUCTION JOBS  
 5,000 INDIRECT JOBS FOR SERVICE  
 3 MILLION SPENDING OFFICE POTENTIAL

NOTE: ALL INFORMATION IS PRELIMINARY AND SUBJECT TO REVISIONS.

**5-6**  
 SHEET  
 NUMBER

**LANDTECH DESIGN GROUP, INC.**  
 REAL ESTATE DEVELOPMENT & CONSULTING  
 385 DONORA BLVD.  
 FORT MYERS, BEACH, FLORIDA 33931  
 813-470-6000 DIRECT 813-482-7618 OFFICE  
 CERTIFICATE OF AUTHORIZATION NO. 27894

**CLOSER TO THE HEART**  
 SPRING WATER TRANSMISSION PLAN  
 FOOT EAST FOOT 1 DESIGN DEVELOPMENT  
 SARASOTA-DESBTO-CHARLOTTE-LEE, FLORIDA  
**GILBERT WATER COMPANY, LLC**  
 TRANSMISSION ALIGNMENT PLAN

DATE	REVISIONS:	BY:

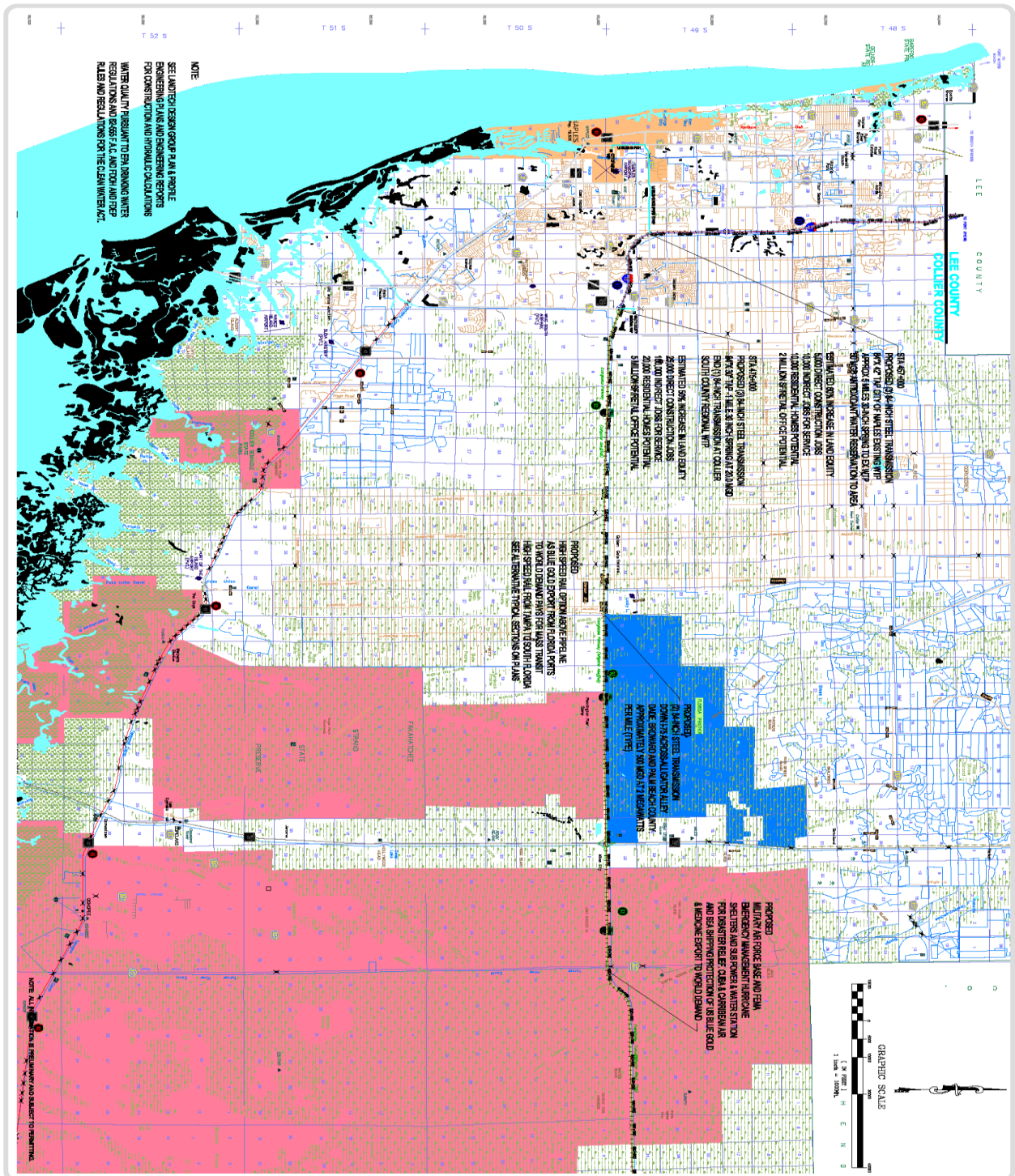

NOTE:  
 SEE LATEST DESIGN GROUP PLAN & PROFILE  
 ENGINEERING PLANS AND PERMISSIVE REPORTS  
 FOR CONSTRUCTION AND FINANCIAL CALCULATIONS  
 WATER QUALITY REGULATORY AND DRINKING WATER  
 REGULATIONS AND CROSS FACILITY AND WATER  
 RULES AND REGULATIONS FOR THE CLEAN WATER ACT.

NOTE: ALL THE INFORMATION IS PRELIMINARY AND SUBJECT TO REVISIONS.

DATE: 7/1/2018  
 SCALE: 1" = 100'  
 SHEET NUMBER: S-7

**LANDTECH DESIGN GROUP, INC.**  
 REAL ESTATE DEVELOPMENT & CONSULTING  
 385 DONORA BLVD  
 FORT MYERS BEACH, FLORIDA 33931  
 813-470-6000 DIRECT | 813-482-7918 OFFICE  
 CERTIFICATE OF AUTHORIZATION No. 17884

**CLOSER TO THE HEART**  
 SPRING WATER TRANSMISSION PLAN  
 FOOT DISTRICT 4 & 6 DESIGN DEVELOPMENT  
 COLLIER-BROWARD-DADE PALM BEACH, FLORIDA  
**GILBERTI WATER COMPANY, LLC**  
 TRANSMISSION ALIGNMENT PLAN

DATE:	REVISIONS:	BY:



**NOTE:**  
 SEE LANDTECH DESIGN GROUP PALM BEACH COUNTY PERMITS AND RECORDS FOR CONSTRUCTION AND FINISHED LOCATIONS.  
 WATER QUALITY PERMITS TO BE OBTAINED UNDER REGULATIONS AND DECS 62.A.C. AND FCRA AND OTHER RULES AND REGULATIONS FOR THE CLEAN WATER ACT.

NOTE: ALL INFORMATION IS PRELIMINARY AND SUBJECT TO REVISION.

DATE: 7/1/15  
 SCALE: 1"=1000'  
 SHEET: 5-8

**LANDTECH DESIGN GROUP, INC.**  
 REAL ESTATE DEVELOPMENT & CONSULTING  
 385 DONORA BLVD  
 FORT MYERS BEACH, FLORIDA 33931  
 813-470-6000 DIRECT 813-482-7918 OFFICE  
 CERTIFICATE OF AUTHORIZATION No. 27894

**CLOSER TO THE HEART**  
 SPRING WATER TRANSMISSION PLAN  
 FOOT DISTRICT 4 & 6 DESIGN DEVELOPMENT  
 COLLEGE ROAD - DUNE PALM BEACH, FLORIDA  
 GILBERT WATER COMPANY, LLC  
 TRANSMISSION ALIGNMENT PLAN

DATE	REVISIONS	BY

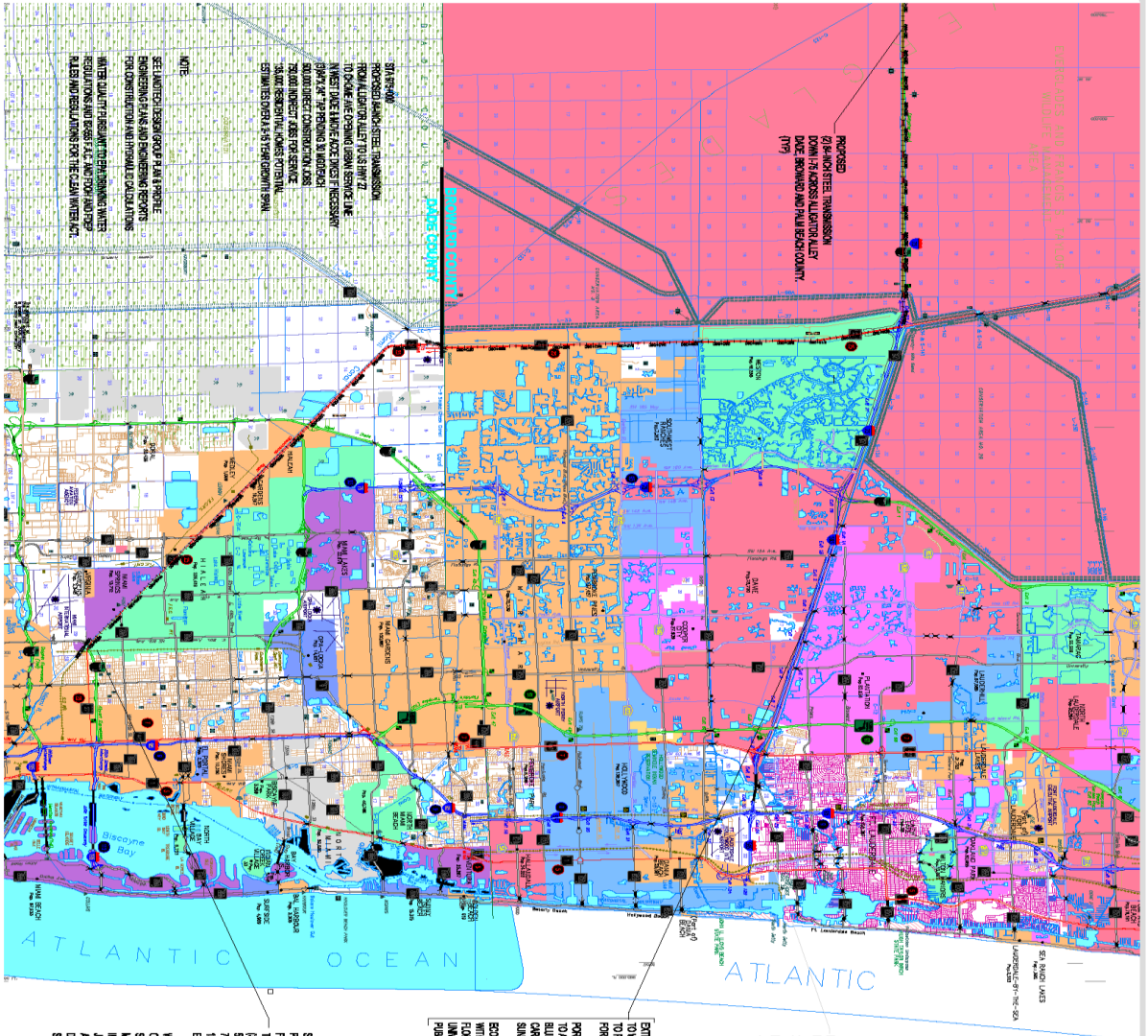

**NOTES:**

SEE LANDTECH DESIGN GROUP, INC. REPORT # 13-000001 FOR CONSTRUCTION AND FINANCIAL CALCULATIONS AND ENGINEERING PLANS AND PERMISSING REPORTS.

WATER QUALITY PLACEMENT TO ENVIRONMENTAL WATER REGULATIONS AND DECS P.L. 14-200 AND DECS P.L. 14-201 AND REGULATIONS FOR THE CLEAN WATER ACT.

**PROPOSED**

HIGH SPEED RAIL OPTIMIZE ROUTE AS BLUE GOLD SPURT FROM FLORIDA PORTS TO WINDWARD BEACHS FOR MASS TRANSIT HIGH SPEED RAIL FROM PALM TO SOUTH FLORIDA SEE ALTERNATIVE TYPICAL SECTIONS ON PLANS

**EXISTING TRANSMISSION LINE SERVICE**

TO PORT FERRIS CONNECTING TO DUNE ISLAND TOWN FORT LAUDERDALE & SOUTHWEST BROWARD CITIES

PORT FERRIS ALIQUID BULK WATER SHIPPING AND SPLITTING TO USA AT PANAMA CANAL AND WIND FOST TO EXPORT BLUE GOLD TO PA/ ON IS HEADHOME PLASPOOLS AND ONE FOR RESIDENTS SERVICE AND FERRIS IN THE SUNSHINE STATE

ECONOMIC GROWTH FROM CHEAPEST WATER IN THE WORLD WITH AN AMOUNT BEING FOR UNIVERSITY OF PALM BEACH, FLORIDA UNIVERSITY AND GLOBAL INTERNATIONAL UNIVERSITY AND GLOBAL RESOURCES PUBLIC HEALTH, MEDICINE AND AGRICULTURAL ISSUES

**50% (2000 AMP)**

PROPOSED 2000 AMP STEEL TRANSMISSION FROM ALA LINDOR ALIQUID TO IS HWY 27 TO WEST DUNE AT MIAMI BEACHES

5000 AMP DIRECT CONSTRUCTION LOSS 750,000 INVEST LOSS FOR SERVICE ESTIMATES OVER A 50 YEAR GROWING SPAN

WITH A LOW WATER TEST 1.2 BEGINS

OF 2000 AMP THIS SUPPORTS ALAQUID WATER WINDWARD BEACHES A RETAIL DEVELOPMENT OTHER INSTANTLY AS BEACHES BEGINS CREATING NEW JOBS TO CLEANER HEALTH FOR CAROLINA PALMES AND ITS OTHERS PRESENTATION TO WIND DUNE HEAD ON JULY 14, 2014 A PARTITION ON 5000 AMP WITH BEACHS IN FOOT SINCE 2012

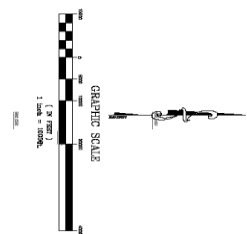

**SHEET**

**1**

**13-000001**

**5-9**

**LANDTECH DESIGN GROUP, INC.**

REAL ESTATE DEVELOPMENT & CONSULTING

380 DONORA BLVD  
FORT MYERS BEACH, FLORIDA 33931  
813-470-6000 DIRECT 813-462-7418 OFFICE

CERTIFICATE OF AUTHORIZATION NO. 27894

**CLOSER TO THE HEART**

**SPRING WATER TRANSMISSION PLAN**

**FOOT DISTRICT 4 & 6 DESIGN DEVELOPMENT**

COLLIER-BROWARD-DADE-PALM BEACH, FLORIDA

GILBERT WATER COMPANY, LLC

TRANSMISSION ALIGNMENT PLAN

DATE:	REVISIONS:	BY: